

“Seven C’S”
2020 Galeon 550 MY



Presented by
Andy Kniffin CPYB
Ak Yachts
(954) 292-0629
andy@akyachts.com

“Seven C’s” 2020 Galeon 550

LOA	58'1"
Beam	15'7"
Draft	4'7"
Clearance	20'1"
Fuel	581 USG
Water	185 USG
Holding	53 USG
Weight	53,462#
Engines	Volvo Penta D11 (725 hp) (318 hrs)
Speed cruise	25 knots
Speed WOT	30 knots
Asking Price	\$1,450,000

Accommodations and Layout.

3 Stateroom, 2 Bath plus Crew

From the aft deck, enter the salon area with the galley first to port. The galley is positioned aft so that it can serve all areas with ease. Note that the stainless framed doors fully swing open to provide full open air access.

Up a few steps there is a huge U-shaped dinette (note hi-lo table) is to port. A small sofa to starboard conceals some cleverly tucked in stools which slide out to make for extra dinette seating. The helm is forward to starboard. Port and starboard windows retract down for open-air living.

So, all of the **wenge wood paneling is a walnut brown, matte finish complemented by white leather and suede. The tone is modern and elegant.** The main deck flooring is similar hard wood (which has carpet runners off-site). Below decks are loose fit carpet (bound edges).

Tall peeps are going to love this boat (headroom is 6'5" throughout)!

Down easy stairs to a foyer area with carpet

The full beam master stateroom is aft and a true statement in luxury! Featuring a centerline king bed, settee to port and plenty of cabinets, hanging space and a safe.

Going forward, a double twin stateroom is to starboard and a VIP almost equal to the Master is forward. The VIP and Twin share a bath/head with access from the foyer area.

A Crew cabin (enter through transom) for a single with a bath/head. The berth folds up when not in use to provide more storage. Access to the engine room is forward of this room.

Galley

The galley is laid out to aft in the salon so that it can easily serve and be a part of all the fun going on in the salon and the aft deck. Note that the salon doors open up fully as an open-air layout when the weather is nice. Also note the privacy curtain for this door. The sliding windows forward in the salon will allow for a nice breeze. Plenty of cabinet storage is available in the galley and salon area. Note ample corian countertop space and a high 'bar' arrangement.

Insignia fridge/freezer (AC type – replaced Dometic DC unit)

Cooktop (2 Burner)

Samsung microwave convection oven

Extraction fan

Flybridge – electric grill, drink fridge, icemaker

Washer/dryer

Electronics and Entertainment

Raymarine 12" Axiom display units (lower helm and flybridge)

Raymarine autopilot

Raymarine radar/sounder

Raymarine VHF remote (lower helm and flybridge)

Volvo electronic engine monitor

Samsung led televisions

Bose home theater system (Salon)

Fusion stereo with Bluetooth (Flybridge and aft deck)

Wifi router

Electrical

Built to US electrical specifications

Onan 17.5 kw genset

Glendinning cablemaster shore system with 50' 50amp cable

Shore power transformer

Led lighting throughout

Underwater lights (2) (renewed 9.22)

Navigation and courtesy led lighting

220/110 VAC distribution panel

24 VDC distribution panel

Battery banks with charger/inverter

Engine Room and Systems

Easy access engine room with two entrances – from galley area or crew area. Stand-up head room and great access around engines and all mechanical systems.

Volvo D11 diesel engines – direct drive (720 hp) (318 hours) with electronic controls

Fuel filters

Fire Suppression system (ER) plus handheld units

Chilled water, tropical air-conditioning (2 compressors) (renewed 9.22 under warranty)

Seakeeper 9 gyro stabilization unit

Bilge pumps and high water alarms

Carbon Monoxide and Fire alarms

Fresh water system

Hot water heater

Planus fresh water heads

Hull and Deck

“Seven C’s” was hauled in August, 2022 for a bottom job (Seahawk Cukote) and prop-speed. The boat received a ceramic coating on all exterior gelcoat surfaces during this time period as well.

Bow and Stern thrusters

Hydraulic swim platform with actuating stairs to aft deck when in lowered position (as a beach)

Teak aft deck, aft steps and swim platform

Trim Tabs

Swim ladder

PWC chocks

Stern access to crew quarters

Covers for all seating (Black sunbrella)

Textaline window covers (in addition to window blinds)

Windows are tinted for UV reflection

Forward windshield wipers

Fiberglass hardtop with a retracting sunshade

Expansive sunpad by helm

Foredeck sunpads and drink holders

Foredeck ‘skylight’ above VIP with retractable pleated shade

Anchor and windlass w/remote both stations

Deck bitts and cleats

Fenders and docklines

USCG safety equipment

Remarks

If you haven't been on a Galeon 550 flybridge, you are missing what could be the finest boat you may ever see in this size range. From her exciting modern lines, to her lovely and bright interior to the high quality systems and workmanship found throughout – you may wonder how other yachts can compete!

The interior layout brings the best out of bright, sunny days with plenty of visibility and the choices between open air or climate control. All three of the staterooms have hullside windows.

Many claims are made for truly 'bristol' condition yachts. **"Seven C's" is truly in this super-fine condition needing nothing.... She is perfectly worked in from a new boat and waiting for it's next owner to enjoy!**

The Galeon 550 is noted for her extremely fine ride in all points of waves and weather.

PWC not included in sale



TRANSOM



AFT DECK



SALON



GALLEY



SALON AFT



SALON FWD



LOWER HELM



MASTER BATH



MASTER STATEROOM



MASTER STATEROOM



VIP STATEROOM



TWIN STATEROOM



FLYBRIDGE AFT



FLYBRIDGE FORWARD



FOREDECK



ENGINE ROOM



AFT VIEW

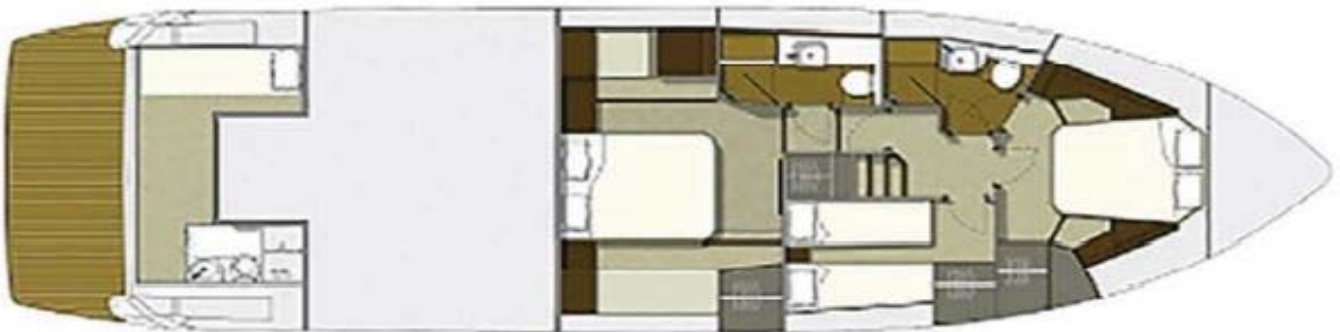

LAYOUT